

Through-the-Wall Fan

MODEL: 8870

DESCRIPTION

- For baths up to 75 sq. ft.
- UL listed for use in tub/shower enclosures when used with GFI branch circuit wiring.
- Telescoping 7" diameter wiring allows exact fit through wood or masonry walls from 4" to 9" thick. Required cutout: 7¹/₈" diameter.
- Louvered grille; all-aluminum exterior parts eliminate maintenance.
- Switch operated: turn fan on and aluminum spring-sealed damper opens automatically; provides weather seal when fan is not operating.
- Refer to NuTone's catalog for a complete listing of accessories to effectively adapt this Fan to your construction requirements.

DESIGN FEATURES

- Air Delivery:** 80 CFM at .03" S.P.
Sound Level: 6.0 Sones.
Dimensions: **Grille:** 8¹/₁₆" x 9¹/₂".
Inside Sleeve: 7" ID x 5¹/₁₆".
Outside Sleeve: 6³/₃₂" ID x 5¹/₁₆".
Flash Plate: 10" square x 3¹/₄".
Hood Extension: 5⁷/₁₆" from wall.
- Material & Finish:** **Grille:** White polymeric, pebble-grain finish.
Inside Sleeve: Cold rolled steel, baked enamel.
Outside Sleeve: Aluminum.
Flash Plate & Hood Assembly: Aluminum.
- Motor:** Plug-in, Thermally protected, 115 volts, 60 Hz, .65 amp.
Fan Blade: One-piece polypropylene propeller. Balanced, 6¹/₂" diameter, 5-leaf.
Electrical Rating: 120v, 60Hz, 1.5A.

ARCHITECT'S SPECIFICATIONS

Through-the-Wall Fan(s) shall be NuTone Model Number 8870 as manufactured by NuTone according to listed specifications. Unit shall ventilate 80 CFM at .03" S.P. at a sound level of 6.0 Sones. Unit shall be equipped with aluminum flash plate and hood and includes adjustable telescoping 7" diameter wall sleeve.

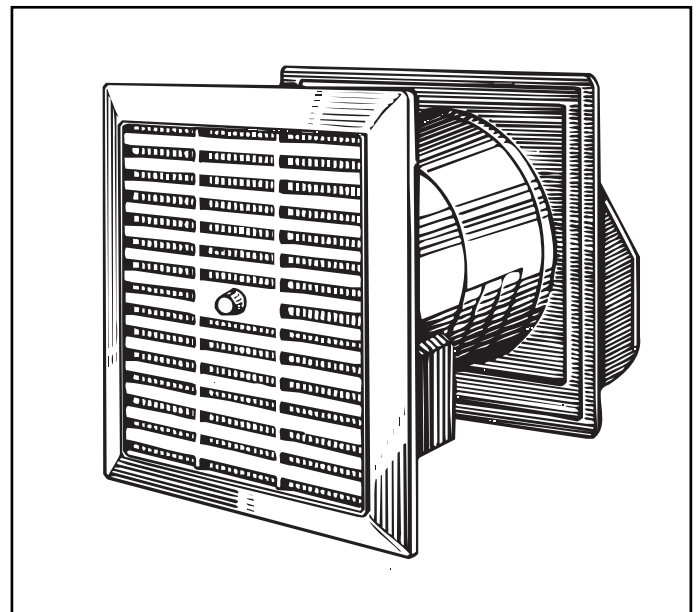

INSTALLATION

- Not for use in kitchens.
- Wall sleeve assembly is installed during rough-in stage of construction. Removable outlet box may be wired at rough-in stage and may be mounted behind plaster or drywall. Includes three (3) wiring knockouts.
- Motor and blade assembly installs quickly over screws mounted on sleeve. Spring-operated aluminum backdraft damper opens automatically when fan is turned on; closes quietly when unit is turned off. Grille installs with thumbscrew provided.
- Features weather seal when fan is not operating. Timer switch sold separately.

CERTIFIED TEST DATA

HVI-2100 CERTIFIED RATINGS comply with new testing technologies and procedures prescribed by the Home Ventilating Institute, for off-the-shelf products, as they are available to consumers. Product performance is rated at .03 in. static pressure, based on tests conducted in AMCA's state-of-the-art test laboratory. Sones are a measure of humanly-perceived loudness, based on laboratory measurements. This NuTone model is listed by Underwriters' Laboratories Inc. and Certified by the Canadian Standards Association (CSA.)



DIMENSIONAL DRAWING

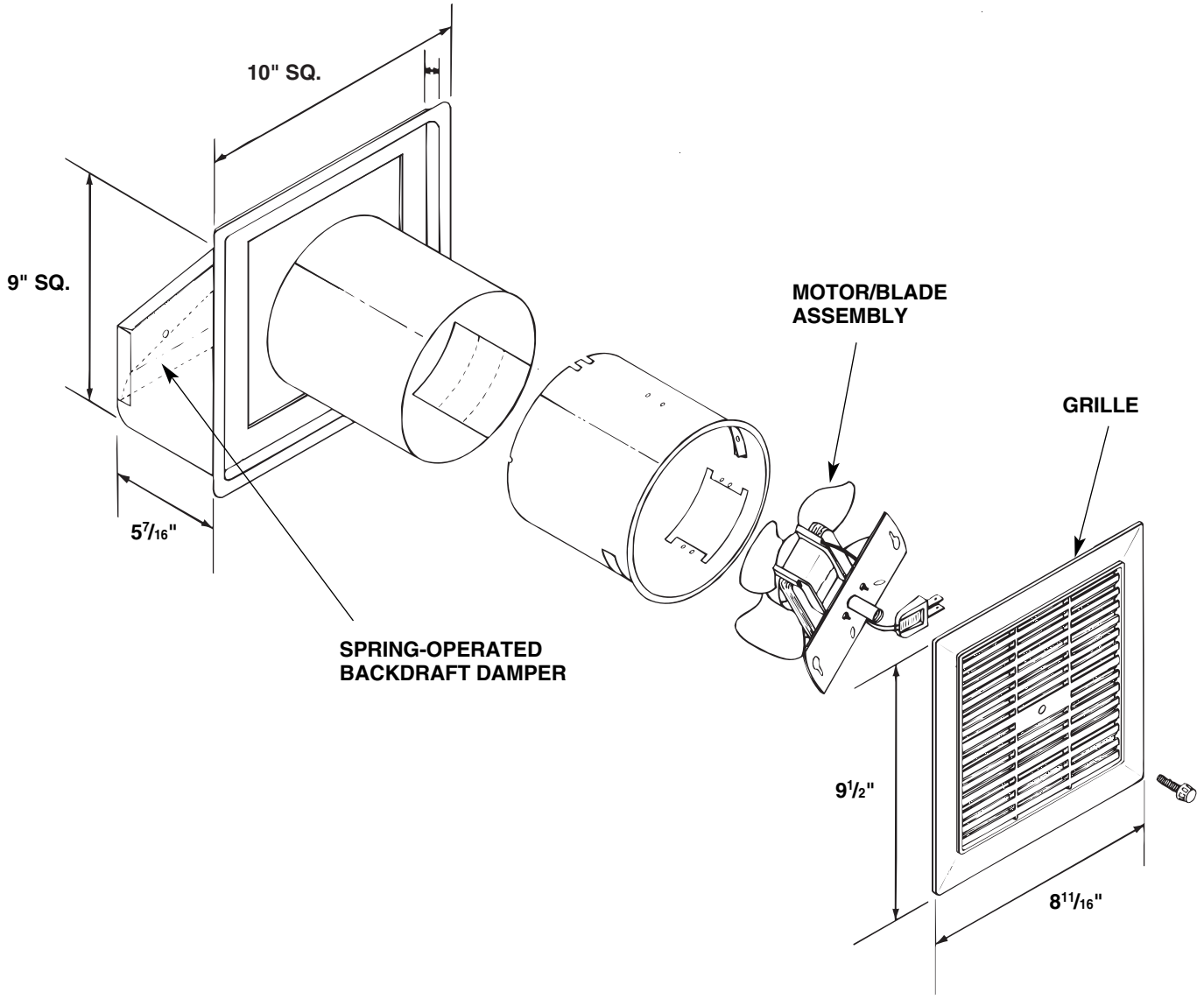

Product specifications subject to change without notice.

NuTone, Inc., 4820 Red Bank Road, Cincinnati, Ohio 45227
Printed in U.S.A.